

THROWBACK BIKES

R-RX Front Moto Fender

Installation Guide

Version 1.3

THANKS FOR PURCHASING THIS FENDER! PLEASE READ ALL INSTRUCTIONS BEFORE INSTALLING. IF YOU HAVE TROUBLE DON'T HESITATE TO CONTACT US AT info@throwbackbikes.com

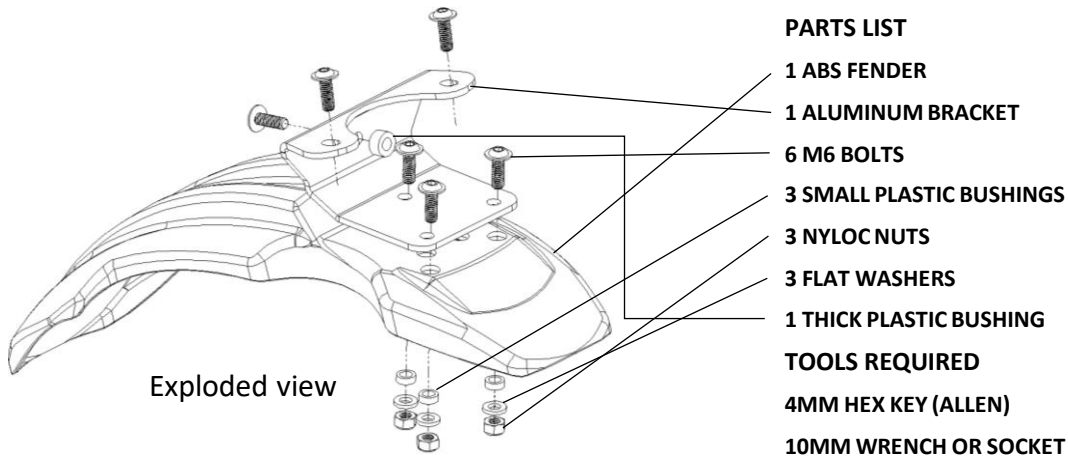

STEP 1. Attach the fender to the bracket using 3 bolts from the top of the bracket. Use the plastic bushings, the washers, and the nuts from the bottom side. Make sure the fender is aligned well before tightening the three bolts. Make sure the bushings are staying in the oversized holes in the fender!

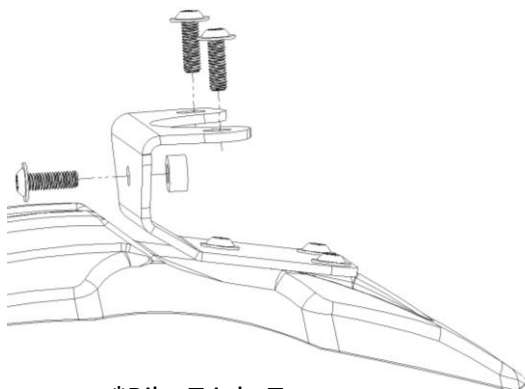
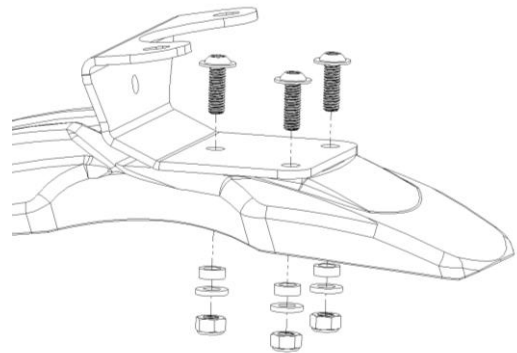

*Bike Triple Tree
Not Shown

STEP 2. Use the provided $\frac{1}{4}$ " thick wide bushing to go behind the hole in the front of the bracket. This bushing will stay between the bracket and your bike's triple-tree and is important. Use it! Slip the front bolt through the bracket and the bushing, then guide the bracket into place on the bike's triple-tree. Next, start threading the front bolt (with the bushing still on it!) into the front center hole on the triple-tree. Next, start the top two bolts into the threaded holes in the triple tree. When all three bolts are started straight, tighten them up, starting with the front bolt.

That's it! We hope you love your new fender.